



**WILLOW HOUSE SHARED OWNERSHIP KENSETT AVENUE**  
**HORSHAM, RH13 9FJ**

**£55,000**  
**LEASEHOLD**

Elton's are delighted to be able to offer this one bedroom second floor flat situated in Southwater village offering spacious accommodation.

**ELTONS**

**Estate Agents**

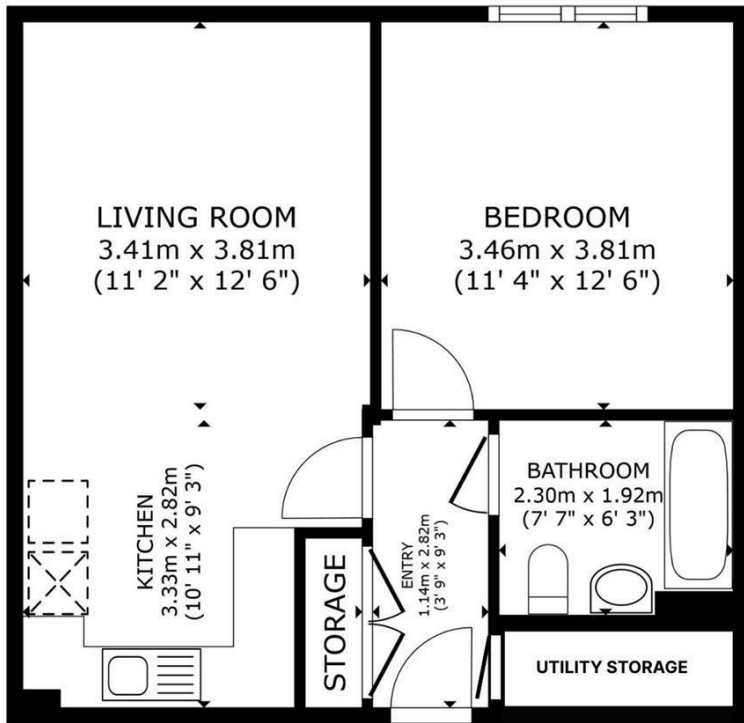

FLOOR PLAN

GROSS INTERNAL AREA  
 FLOOR PLAN 44.8 m<sup>2</sup> (482 sq.ft.)  
 TOTAL : 44.8 m<sup>2</sup> (482 sq.ft.)  
 SIZES AND DIMENSIONS ARE APPROXIMATE, ACTUAL MAY VARY.

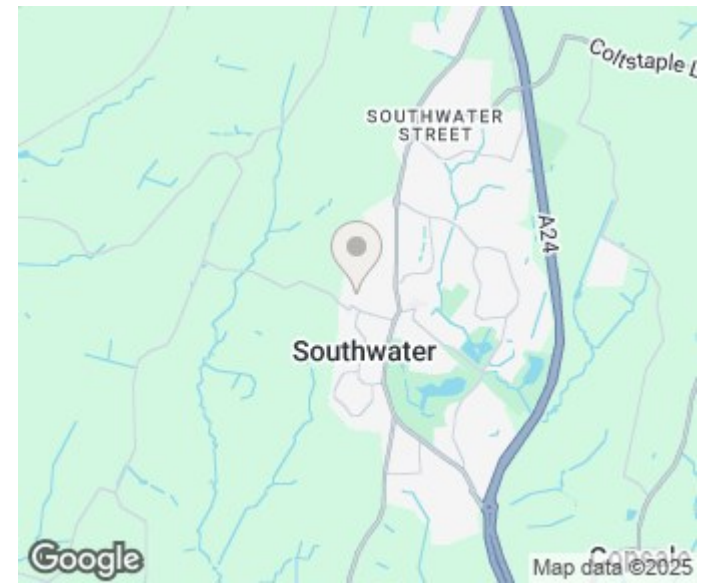

Energy Efficiency Rating		Current	Potential
Very energy efficient - lower running costs			
(92 plus) A			
(81-91) B		83	83
(69-80) C			
(55-68) D			
(39-54) E			
(21-38) F			
(1-20) G			
Not energy efficient - higher running costs			
England & Wales		EU Directive 2002/91/EC	



Agents Note: Whilst every care has been taken to prepare these particulars, they are for guidance purposes only. All measurements are approximate and are for general guidance purposes only and whilst every care has been taken to ensure their accuracy, they should not be relied upon and potential buyers/tenants are advised to recheck the measurements

Eltons Estate Agents Horsham  
 13 - 15 Queen Street  
 Horsham  
 West Sussex  
 RH13 5AA

01403 299 771  
 sales@eltons.co.uk  
 eltons.co.uk

**ELTONS**

Estate Agents